

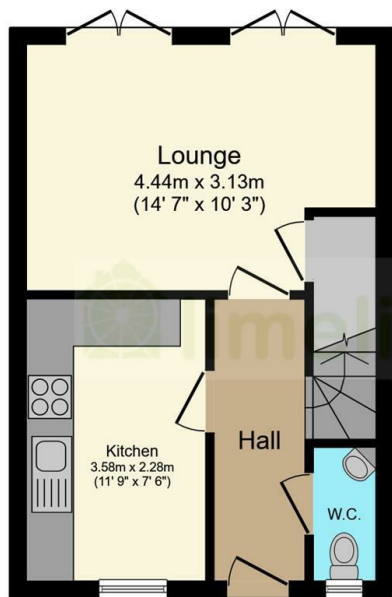

## 9 Stormont Grove, Inkersall, Chesterfield, S43 3JG

Offers Around £169,950

- Modern End Town House
- Lounge
- Bathroom
- NO Chain!
- Popular Location
- Kitchen Diner & D/st WC Rm
- Grdens Front & Rear
- Good Range of Nearby Amenities & Schools
- TWO Bedrooms
- Off Road Parking



Ground Floor

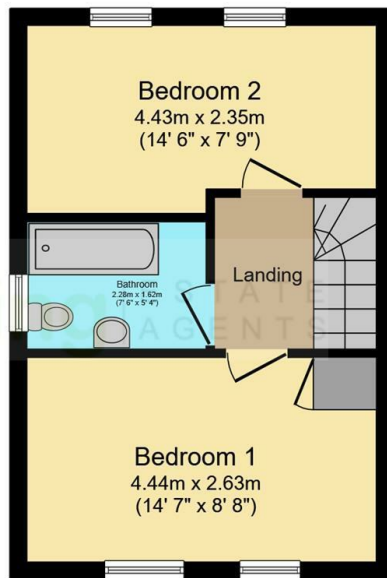

First Floor

Total floor area: 60.5 sq.m. (651 sq.ft.)

This floor plan is for illustrative purposes only. It is not drawn to scale. Any measurements, floor areas (including any total floor area), openings and orientations are approximate. No details are guaranteed, they cannot be relied upon for any purpose and do not form any part of any agreement. No liability is taken for any error, omission or misstatement. A party must rely upon its own inspection(s). Powered by www.Propertybox.io

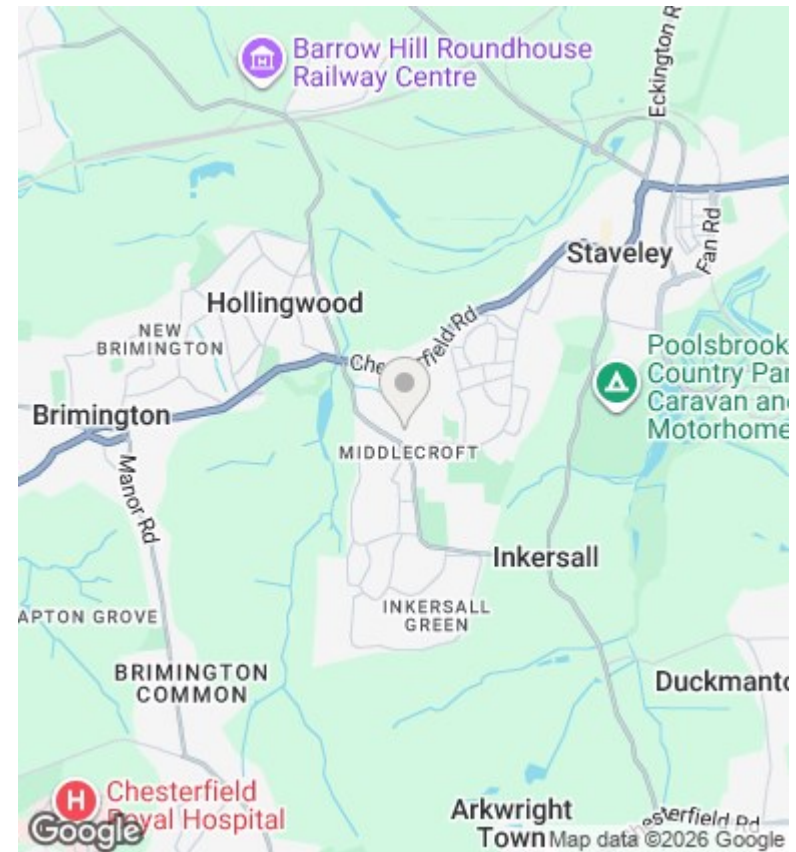

## Directions

## Viewings

Viewings by arrangement only. Call 01246 275 559 to make an appointment.

## Council Tax Band

A

## EPC Rating:

C

Energy Efficiency Rating		Current	Potential
Very energy efficient - lower running costs			
(92 plus) A			90
(81-91) B			
(69-80) C		74	
(55-68) D			
(39-54) E			
(21-38) F			
(1-20) G			
Not energy efficient - higher running costs			
<b>England &amp; Wales</b>		EU Directive 2002/91/EC	